

LipuJet-P-OA

Product information for the product group



ACO Product benefits

- With two inspection windows for sludge and grease control
 - With two high pressure spray heads for perfect inner body cleaning
 - Control unit with presets and flexible adjustments (cleaning and filling times)
- Grease separator according to EN 1825 for installation inside frost-free rooms
 - Manufactured of polyethylene in oval shape
 - Two covers odour-proof Ø 450 mm
 - Inlet and outlet Ø 200 mm (NS 15 – 25) or Ø 250 mm (NS 30)
- Disposal connection Ø 75 mm with Storz-B coupling R 2½"
 - Two automatically operated high pressure pumps (3,9 kW each) and connection high pressure spray heads (150 bar) for combined mixing of the content and cleaning of the tank
 - Automatically operated filling device R ¾" via solenoid valve
- Two inspection windows with wiper
 - Operating side left or right

Item Technical Data 3815.75.42

Nominal capacity	Contents			Operation side
	Sludge trap [l]	Grease store [l]	Overall [l]	
NS 15	1580	630	2850	Right-hand

Dimensions

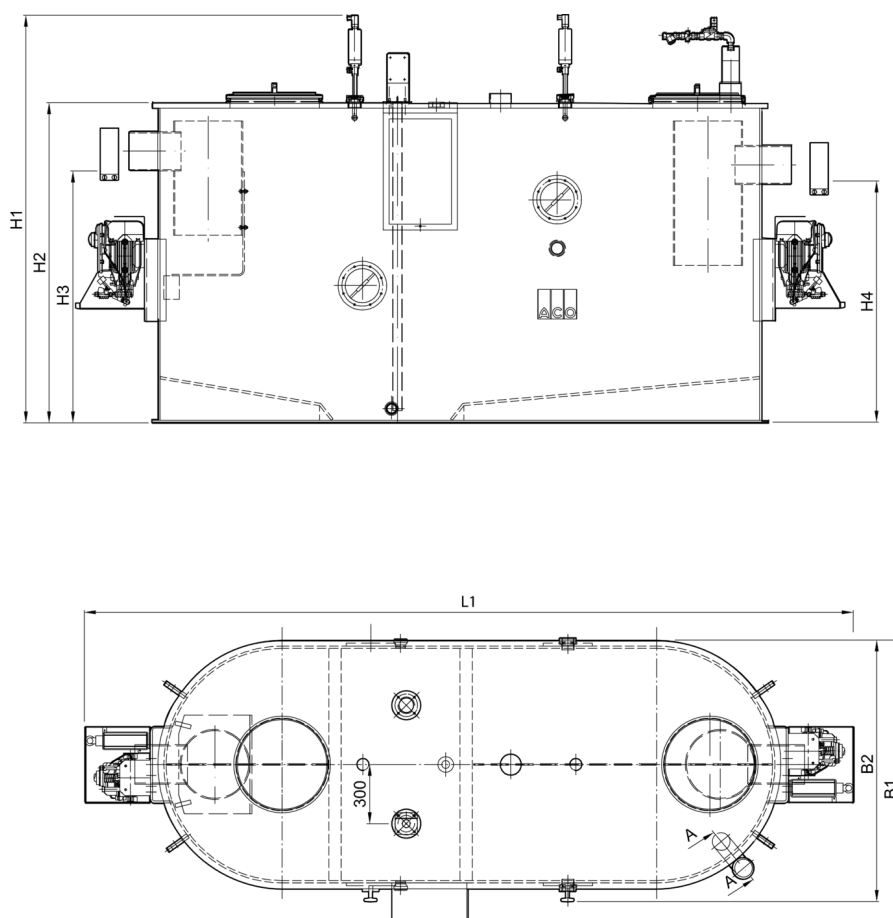

Nominal capacity	Dimensions						
	L1 [mm]	H1 [mm]	H2 [mm]	H3 [mm]	H4 [mm]	W1 [mm]	W2 [mm]
NS 15	3210	2090	1640	1300	1230	1530	1340

Accessories

	Description	Used with	Description	Item number
	Inlet valve DN 200		<ul style="list-style-type: none"> Weight: 8.4 kg 	0170.20.83

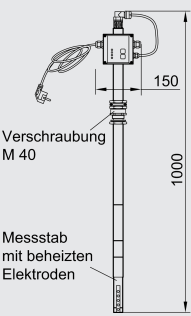
	Description	Used with	Description	Item number
	Grease layer thickness measuring device	<ul style="list-style-type: none"> ■ LipuJet-P <ul style="list-style-type: none"> □ Oval NS 1 – 10 □ Round NS 2 – 20 ■ LipuJet-S <ul style="list-style-type: none"> □ Oval NS 1 – 10 □ Round NS 2 – 20 ■ LipuSmart-P <ul style="list-style-type: none"> □ Oval NS 1 – 10 	<ul style="list-style-type: none"> ■ For electronic measurement of layer of grease ■ Suitable for liquid and/or congealing grease ■ Measuring device with plug and used connecting cable, length: 3 m ■ With two voltage-free changeover contacts to display full warning (80 %) and advance warning of fill level (50 %) ■ With visual display of fill level ■ With heated probe rod to increase reliability of operation ■ Operating voltage: 230VAC/5 VA ■ Max consumption approx. 12 W ■ Weight: 2.8 kg 	3300.11.50
	Connection box		<ul style="list-style-type: none"> ■ Weight: 10 kg 	7601.80.24

You can find further accessories under → [/38157542](#)